

© 2022 Microsoft Corporation © 2022 Maxar, CNES (2022)

- LEGEND**
- PROPOSED MF-14 | 46.49 AC
 - PROPOSED MF-30 | 16.14 AC
 - PROPOSED GC | 3.83 AC
 - PROPOSED PGOS | 44.95 AC
 - EXIST. ROCK OUTCROPPING TO REMAIN
 - EXIST. ROCK OUTCROPPING TO BE POTENTIALLY DISTURBED BY FEATHER GRADING OPERATIONS
 - EXIST. ROCK OUTCROPPING TO BE REMOVED

TABLE 4-4 REQUIRED OPEN SPACE IN HILLSIDE DEVELOPMENTS			
SLOPE RANGE	A. MIN. OPEN SPACE RANGE	B. ACRES WITHIN SLOPE RANGE	C. REQUIRED OPEN SPACE WITHIN EACH SLOPE RANGE
			(ACRES)
0-10%	0	20.12	0.00
10.1-20%	25	17.91	4.51
20.1-25%	50	14.96	7.51
25.1-30%	75	8.32	12.51
30.1-35%	100	9.31	23.27
35.1-40%	125	9.31	33.41
40.1-45%	150	9.31	43.55
45.1-50%	175	9.31	53.69
50.1-55%	200	9.31	63.83
55.1-60%	225	9.31	73.97
60.1-65%	250	9.31	84.11
65.1-70%	275	9.31	94.25
70.1-75%	300	9.31	104.39
75.1-80%	325	9.31	114.53
80.1-85%	350	9.31	124.67
85.1-90%	375	9.31	134.81
90.1-95%	400	9.31	144.95
95.1-100%	425	9.31	155.09
TOTAL			26.4

GRADING ENCROACHMENTS IN SLOPES GREATER THAN 20%
HILLSIDE DEVELOPMENT (RED) OPEN SPACE: 26.40 AC
TOTAL OPEN SPACE REQUIRED: 26.40 AC
2:1 RATIO ADJ. OPEN SPACE REQ'D: 3.89 AC
TOTAL OPEN SPACE PROVIDED: 46.49 AC

LUMOS & ASSOCIATES
9222 PROTOTYPE DRIVE
SUITE 100
TEL: 772.827.8111
WWW.LUMOSINC.COM

© LUMOS ASSOCIATES, INC. THE DRAWINGS ARE THE PROPERTY OF LUMOS ASSOCIATES, INC. NO PART OF THESE DRAWINGS MAY BE REPRODUCED OR TRANSMITTED IN ANY FORM OR BY ANY MEANS, ELECTRONIC OR MECHANICAL, WITHOUT THE WRITTEN PERMISSION OF LUMOS ASSOCIATES, INC. THE CLIENT AGREES TO HOLD LUMOS ASSOCIATES, INC. HARMLESS FROM ANY AND ALL CLAIMS, DAMAGES, LOSSES AND EXPENSES, INCLUDING REASONABLE ATTORNEY'S FEES, INCURRED BY LUMOS ASSOCIATES, INC. IN CONNECTION WITH THE PROJECT FOR WHICH THE DRAWINGS WERE PREPARED.

CADO SV LAND LLC
WASHOE
RENO
HIGHLAND - TENTATIVE MAP AND
CONDITIONAL USE PERMIT
ZONING WITH GRADING AND OUTCROPS

SEPTEMBER 2022
PRELIMINARY
BY: _____
REV: _____
DATE: _____
DESCRIPTION: _____

Exhibit F
DRAWN BY: _____
DESIGNED BY: _____
CHECKED BY: _____
JOB NO.: _____

VILLAGE 2 OUTCROPPING PROTECTION SAMPLE

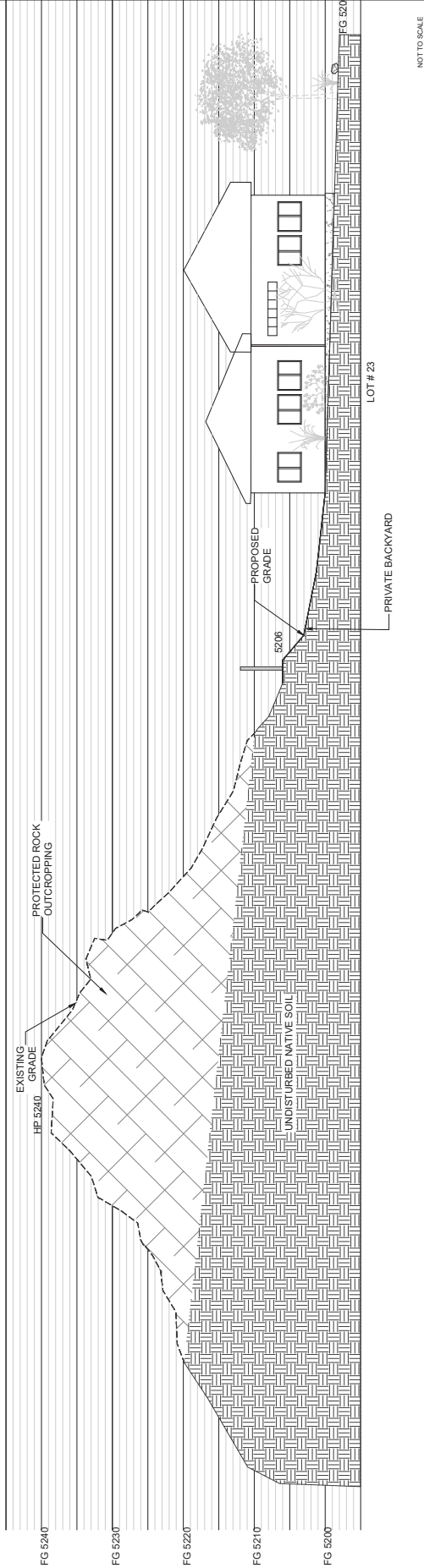

Cross Section Samples
HIGHLAND MIXED USE
CADO SV Land

No.	Revision	Date

L.A. No.	816-260-07-02
Designed	WGP
Drawn	WGP
Checked	MC
Date	8/9/22

PROGRESS SET
Not for Construction

Sheet	L1	of	1
-------	----	----	---